

# Seizure Action Plan

Effective Date \_\_\_\_\_

**This student is being treated for a seizure disorder. The information below should assist you if a seizure occurs during school hours.**

Student's Name	Date of Birth	
Parent/Guardian	Phone	Cell
Other Emergency Contact	Phone	Cell
Treating Physician	Phone	
Significant Medical History		

## Seizure Information

Seizure Type	Length	Frequency	Description

Seizure triggers or warning signs: \_\_\_\_\_

Student's response after a seizure: \_\_\_\_\_

## Basic First Aid: Care & Comfort

Please describe basic first aid procedures:

Does student need to leave the classroom after a seizure?  Yes  No

If YES, describe process for returning student to classroom: \_\_\_\_\_

## Basic Seizure First Aid

- Stay calm & track time
  - Keep child safe
  - Do not restrain
  - Do not put anything in mouth
  - Stay with child until fully conscious
  - Record seizure in log
- For tonic-clonic seizure:**
- Protect head
  - Keep airway open/watch breathing
  - Turn child on side

## Emergency Response

A "seizure emergency" for this student is defined as:

### Seizure Emergency Protocol

(Check all that apply and clarify below)

- Contact school nurse at \_\_\_\_\_
- Call 911 for transport to \_\_\_\_\_
- Notify parent or emergency contact
- Administer emergency medications as indicated below
- Notify doctor
- Other \_\_\_\_\_

### A seizure is generally considered an emergency when:

- Convulsive (tonic-clonic) seizure lasts longer than 5 minutes
- Student has repeated seizures without regaining consciousness
- Student is injured or has diabetes
- Student has a first-time seizure
- Student has breathing difficulties
- Student has a seizure in water

## Treatment Protocol During School Hours (include daily and emergency medications)

Emerg. Med. ✓	Medication	Dosage & Time of Day Given	Common Side Effects & Special Instructions

Does student have a Vagus Nerve Stimulator?  Yes  No If YES, describe magnet use: \_\_\_\_\_

## Special Considerations and Precautions (regarding school activities, sports, trips, etc.)

Describe any special considerations or precautions:

Physician Signature \_\_\_\_\_ Date \_\_\_\_\_

Parent/Guardian Signature \_\_\_\_\_ Date \_\_\_\_\_

**FARE**

Food Allergy Research &amp; Education

**FOOD ALLERGY & ANAPHYLAXIS EMERGENCY CARE PLAN****PLACE  
PICTURE  
HERE**

Name: \_\_\_\_\_ D.O.B.: \_\_\_\_\_

Allergy to: \_\_\_\_\_

Weight: \_\_\_\_\_ lbs. Asthma:  Yes (higher risk for a severe reaction)  No**NOTE: Do not depend on antihistamines or inhalers (bronchodilators) to treat a severe reaction. USE EPINEPHRINE.****Extremely reactive to the following allergens:** \_\_\_\_\_

THEREFORE:

 If checked, give epinephrine immediately if the allergen was LIKELY eaten, for ANY symptoms. If checked, give epinephrine immediately if the allergen was DEFINITELY eaten, even if no symptoms are apparent.**FOR ANY OF THE FOLLOWING:  
SEVERE SYMPTOMS****LUNG**Short of breath,  
wheezing,  
repetitive cough**HEART**Pale, blue,  
faint, weak  
pulse, dizzy**THROAT**Tight, hoarse,  
trouble  
breathing/  
swallowing**MOUTH**Significant  
swelling of the  
tongue and/or lips**SKIN**Many hives over  
body, widespread  
redness**GUT**Repetitive  
vomiting, severe  
diarrhea**OTHER**Feeling  
something bad is  
about to happen,  
anxiety, confusion**OR A  
COMBINATION**  
of symptoms  
from different  
body areas.

- 1. INJECT EPINEPHRINE IMMEDIATELY.**
- 2. Call 911.** Tell emergency dispatcher the person is having anaphylaxis and may need epinephrine when emergency responders arrive.
  - Consider giving additional medications following epinephrine:
    - » Antihistamine
    - » Inhaler (bronchodilator) if wheezing
  - Lay the person flat, raise legs and keep warm. If breathing is difficult or they are vomiting, let them sit up or lie on their side.
  - If symptoms do not improve, or symptoms return, more doses of epinephrine can be given about 5 minutes or more after the last dose.
  - Alert emergency contacts.
  - Transport patient to ER, even if symptoms resolve. Patient should remain in ER for at least 4 hours because symptoms may return.

**MILD SYMPTOMS****NOSE**Itchy/runny  
nose,  
sneezing**MOUTH**

Itchy mouth

**SKIN**A few hives,  
mild itch**GUT**Mild nausea/  
discomfort**FOR MILD SYMPTOMS FROM MORE THAN ONE  
SYSTEM AREA, GIVE EPINEPHRINE.****FOR MILD SYMPTOMS FROM A SINGLE SYSTEM  
AREA, FOLLOW THE DIRECTIONS BELOW:**

1. Antihistamines may be given, if ordered by a healthcare provider.
2. Stay with the person; alert emergency contacts.
3. Watch closely for changes. If symptoms worsen, give epinephrine.

**MEDICATIONS/DOSES**

Epinephrine Brand or Generic: \_\_\_\_\_

Epinephrine Dose:  0.15 mg IM  0.3 mg IM

Antihistamine Brand or Generic: \_\_\_\_\_

Antihistamine Dose: \_\_\_\_\_

Other (e.g., inhaler-bronchodilator if wheezing): \_\_\_\_\_

PATIENT OR PARENT/GUARDIAN AUTHORIZATION SIGNATURE

DATE

PHYSICIAN/HCP AUTHORIZATION SIGNATURE

DATE



## EPIPEN® AUTO-INJECTOR DIRECTIONS

1. Remove the EpiPen Auto-Injector from the clear carrier tube.
2. Remove the blue safety release by pulling straight up without bending or twisting it.
3. Swing and firmly push orange tip against mid-outer thigh until it 'clicks'.
4. Hold firmly in place for 3 seconds (count slowly 1, 2, 3).
5. Remove auto-injector from the thigh and massage the injection area for 10 seconds.

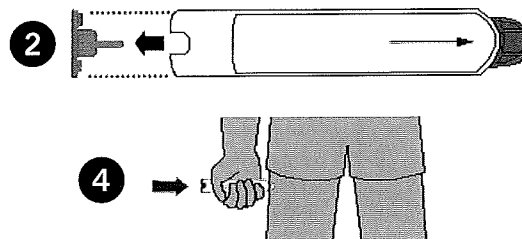

## ADRENACLICK® (EPINEPHRINE INJECTION, USP) AUTO-INJECTOR DIRECTIONS

1. Remove the outer case.
2. Remove grey caps labeled "1" and "2".
3. Place red rounded tip against mid-outer thigh.
4. Press down hard until needle enters thigh.
5. Hold in place for 10 seconds. Remove from thigh.

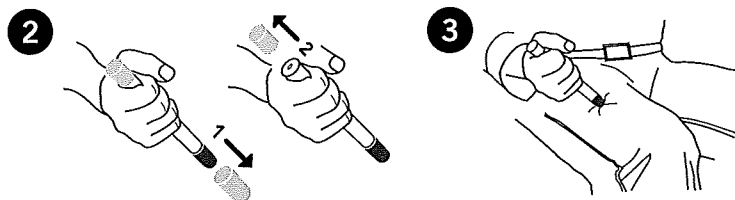

## ADMINISTRATION AND SAFETY INFORMATION FOR ALL AUTO-INJECTORS:

1. Do not put your thumb, fingers or hand over the tip of the auto-injector or inject into any body part other than mid-outer thigh. In case of accidental injection, go immediately to the nearest emergency room.
2. If administering to a young child, hold their leg firmly in place before and during injection to prevent injuries.
3. Epinephrine can be injected through clothing if needed.
4. Call 911 immediately after injection.

## OTHER DIRECTIONS/INFORMATION (may self-carry epinephrine, may self-administer epinephrine, etc.):

Treat the person before calling emergency contacts. The first signs of a reaction can be mild, but symptoms can worsen quickly.

### EMERGENCY CONTACTS — CALL 911

RESCUE SQUAD: \_\_\_\_\_

DOCTOR: \_\_\_\_\_ PHONE: \_\_\_\_\_

PARENT/GUARDIAN: \_\_\_\_\_ PHONE: \_\_\_\_\_

### OTHER EMERGENCY CONTACTS

NAME/RELATIONSHIP: \_\_\_\_\_

PHONE: \_\_\_\_\_

NAME/RELATIONSHIP: \_\_\_\_\_

PHONE: \_\_\_\_\_



## CAMP INDEPENDENCE Medication Administration Form

This Form is to accompany all medications (over the counter and prescription) that are kept and administered at Camp Independence

Camper's Name \_\_\_\_\_ Camper's Date of Birth \_\_\_\_\_

To Be Completed by Parent or Guardian:

1. I request that Camp Independence administer the medication(s) listed below that are requested by his/her physician.
2. I will deliver the medication(s) to Camp Independence in a container labeled by the pharmacy which includes the name and dosage of the medication, unless other arrangements have been made.

Signature \_\_\_\_\_ Relationship \_\_\_\_\_ Date \_\_\_\_\_

Medication	Dosage/Strength	When/Time	How is it taken?	Location	Side Effects to Watch for